

INDEX SHEET

Legend:

- Stage I (Lots 9, 10, 12 & 13)
- Stage II (Lots 6 - 8)
- Stage III (Lots 3 & 4)
- Stage IV (Lots 1 & 11)

**South
Pacific
Ocean**

This plan has been prepared for the purpose of obtaining a Resource Consent pursuant to the provisions of the Resource Management Act 1991. Unauthorised copying or use of this plan for any other purpose is not permitted without the prior consent of Surveying The Bay Ltd. Areas and dimensions shown on this plan are approximate only and are subject to confirmation by survey.

LOCAL AUTHORITY : CENTRAL HAWKES BAY DISTRICT
 ZONING : RURAL
 TOTAL AREA : 111.9000 ha
 COMPRISED IN : RT 674477
 REGISTERED OWNERS : SR & BJ WILLIAMS CHARITABLE TRUST BOARD

**SR & BJ WILLIAMS
CHARITABLE TRUST BOARD**

PROPOSED SUBDIVISION OF
 LOT 2 DP 481291
 402 MANGAKURI ROAD,
 MANGAKURI

SURVEYING THE BAY
 HAWKES BAY | NEW ZEALAND

PO Box 611, Hastings, NZ
 Phone: +64 6 870 4048 or 0800 787 842
 Fax: +64 6 870 4042
 info@surveyingthebay.co.nz
 www.surveyingthebay.co.nz

STAGING PLAN

1: 6,000 @ A3
 AUGUST 2023

4698-31

PT

1/6

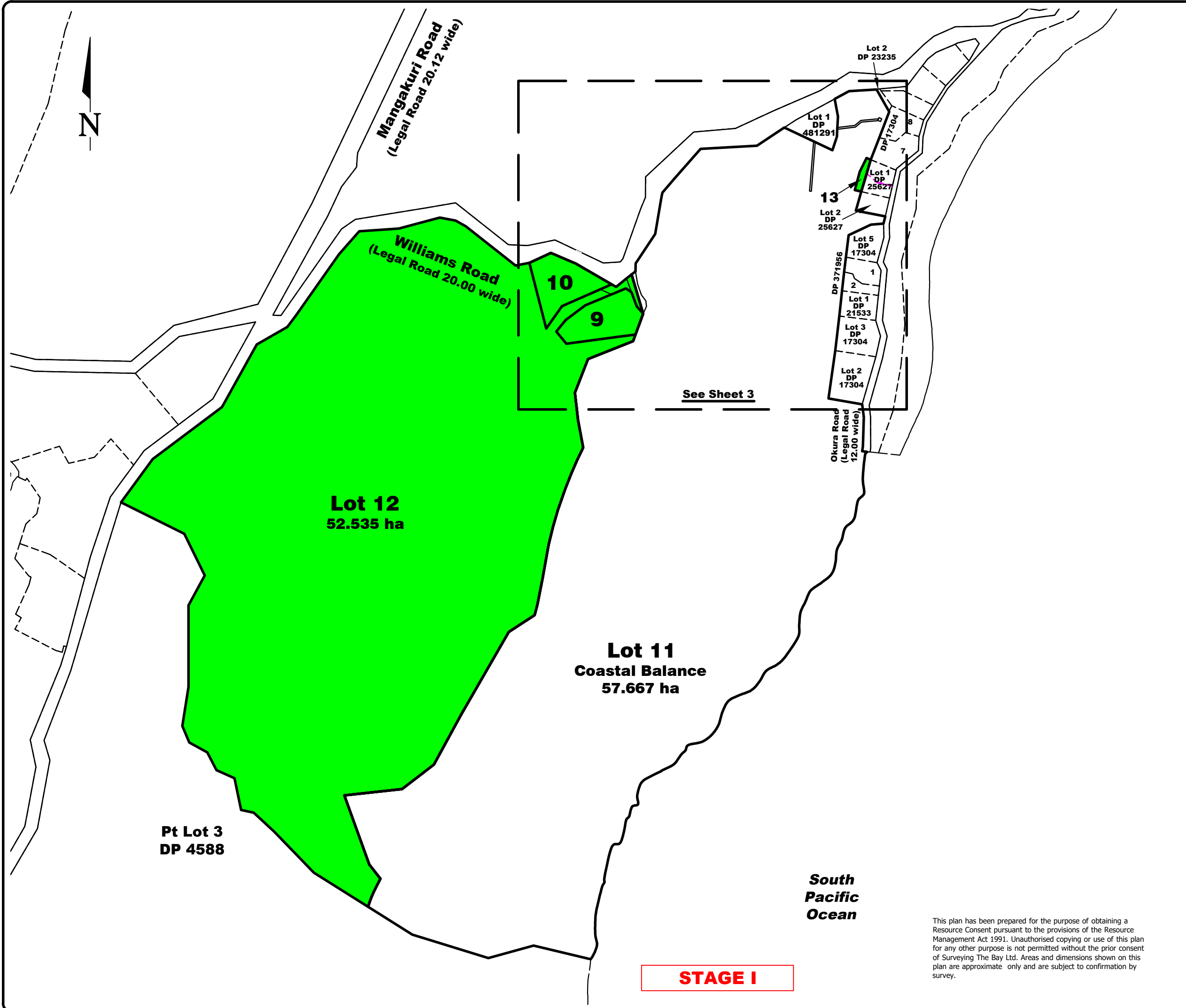

LOCAL AUTHORITY : CENTRAL HAWKES BAY DISTRICT
 ZONING : RURAL
 TOTAL AREA : 111.9000 ha
 COMPRISED IN : RT 674477
 REGISTERED OWNERS : SR & BJ WILLIAMS CHARITABLE TRUST BOARD

PROPOSED SUBDIVISION OF
 LOT 2 DP 481291
 402 MANGAKURI ROAD,
 MANGAKURI

PO Box 611, Hastings, NZ
 Phone: +64 6 870 4048 or 0800 787 842
 Fax: +64 6 870 4042
 info@surveyingthebay.co.nz
 www.surveyingthebay.co.nz

1: 6,000 @ A3
 AUGUST 2023

4698-31 | 2/6

This plan has been prepared for the purpose of obtaining a Resource Consent pursuant to the provisions of the Resource Management Act 1991. Unauthorised copying or use of this plan for any other purpose is not permitted without the prior consent of Surveying The Bay Ltd. Areas and dimensions shown on this plan are approximate only and are subject to confirmation by survey.

This plan has been prepared for the purpose of obtaining a Resource Consent pursuant to the provisions of the Resource Management Act 1991. Unauthorised copying or use of this plan for any other purpose is not permitted without the prior consent of Surveying The Bay Ltd. Areas and dimensions shown on this plan are approximate only and are subject to confirmation by survey.



NOTES:

1. K1, P9 & P10 ARE COVENANT AREAS REQUIRING PLANTING.
2. D & E ARE TO BE "RIGHTS TO ROAM".

PROPOSED AMALGAMATION:

THAT LOT 13 HEREON BE TRANSFERRED TO THE OWNERS OF LOT 1 DP 25627 AND THAT ONE RECORD OF TITLE BE ISSUED TO INCLUDE BOTH PARCELS.

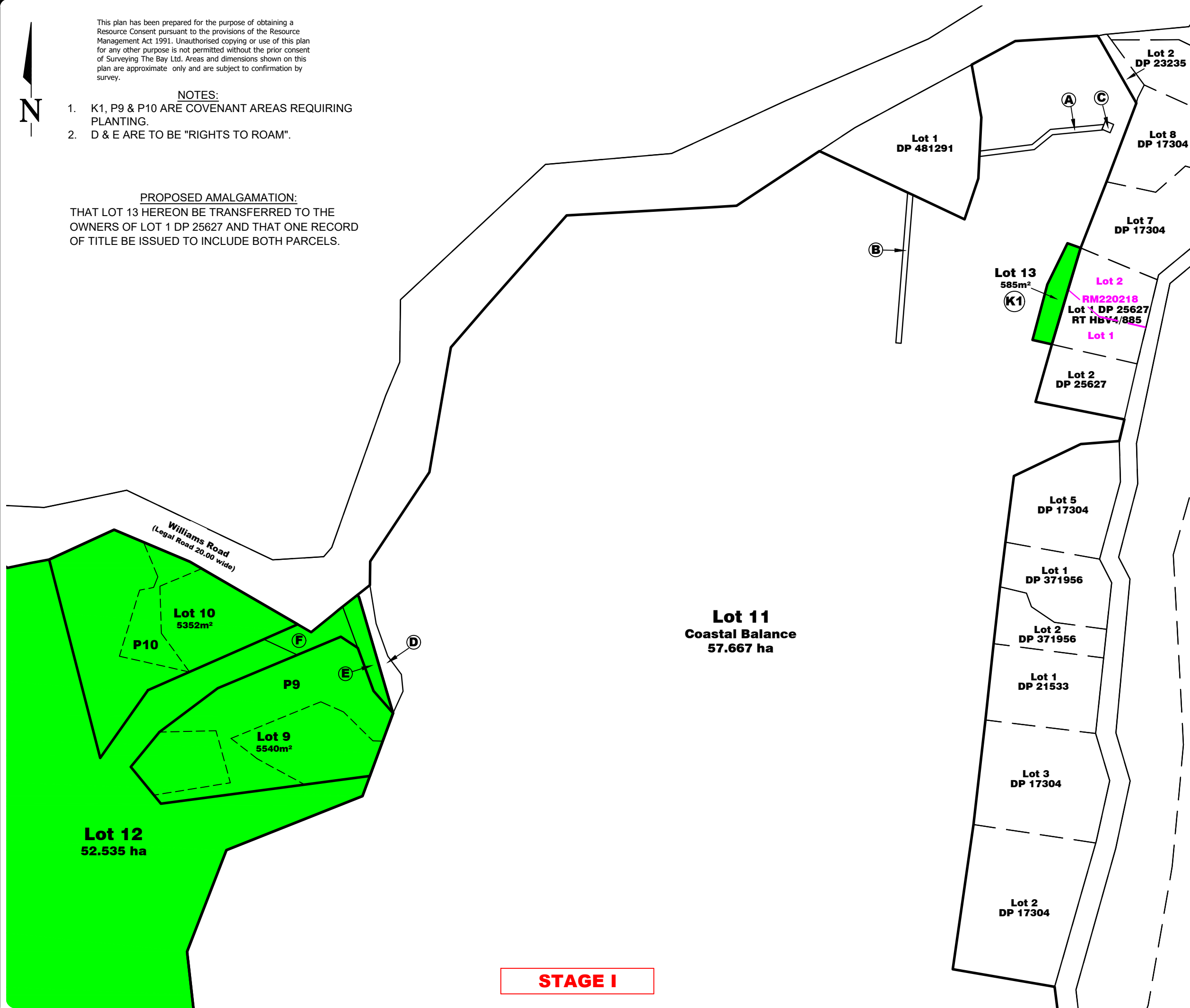

LOCAL AUTHORITY	: CENTRAL HAWKES BAY DISTRICT
ZONING	: RURAL
TOTAL AREA	: 111.9000 ha
COMPRISED IN	: RT 674477
REGISTERED OWNERS	: SR & BJ WILLIAMS CHARITABLE TRUST BOARD

PROPOSED EASEMENTS

PURPOSE	SHOWN	SERVIENT TENEMENT	DOMINANT TENEMENT
RIGHT OF WAY, RIGHTS TO DRAIN WATER & RIGHTS TO CONVEY ELECTRICITY & TELECOMMUNICATIONS	D	LOT 11	LOTS 9,10 & 12
	E	LOT 12	LOTS 9-11
	F	LOT 12	LOT 10
RIGHT TO DRAIN WATER	K1	LOT 13	LOT 11

SCHEDULE OF EXISTING EASEMENTS

PURPOSE	SHOWN	SERVIENT TENEMENT	DOC.
RIGHT TO CONVEY ELECTRICITY	A	LOT 11	9894516.5
RIGHT TO CONVEY TELECOMMUNICATIONS AND COMPUTER MEDIA	B	LOT 11	

SCHEDULE OF EXISTING EASEMENT IN GROSS IN FAVOUR OF CENTRALINES LTD

PURPOSE	SHOWN	SERVIENT TENEMENT	DOC.
RIGHT TO CONVEY ELECTRICITY, TELECOMMUNICATIONS AND COMPUTER MEDIA	C	LOT 11	10063186.1

SR & BJ WILLIAMS CHARITABLE TRUST BOARD

PROPOSED SUBDIVISION OF
LOT 2 DP 481291
402 MANGAKURI ROAD,
MANGAKURI

SURVEYING THE BAY
HAWKES BAY | NEW ZEALAND

PO Box 611, Hastings, NZ
Phone: +64 6 870 4048 or 0800 787 842
Fax: +64 6 870 4042
info@surveyingthebay.co.nz
www.surveyingthebay.co.nz

STAGING PLAN

1: 2,000 @ A3
AUGUST 2023
4698-31 | 3/6

STAGE I

This plan has been prepared for the purpose of obtaining a Resource Consent pursuant to the provisions of the Resource Management Act 1991. Unauthorised copying or use of this plan for any other purpose is not permitted without the prior consent of Surveying The Bay Ltd. Areas and dimensions shown on this plan are approximate only and are subject to confirmation by survey.



NOTES:

1. K1, P1, P3, P4, P6 TO P8 ARE COVENANT AREAS REQUIRING PLANTING.
2. P11 TO P16 ARE EASEMENTS FOR PLANTING.
3. D, E, G, H, J, P11 TO P17, R1 & R2 ARE TO BE "RIGHTS TO ROAM".

EXISTING EASEMENTS FROM PREVIOUS STAGE

PURPOSE	SHOWN	SERVIENT TENEMENT	DOMINANT TENEMENT
RIGHT OF WAY, RIGHTS TO DRAIN WATER & RIGHTS TO CONVEY ELECTRICITY & TELECOMMUNICATIONS	D	LOT 11	LOTS 9, 10, 12
	E	LOT 12	LOTS 6 - 11
	F		LOT 10
RIGHT TO DRAIN WATER	K1	LOT 13	LOTS 6, 7, 8 & 11

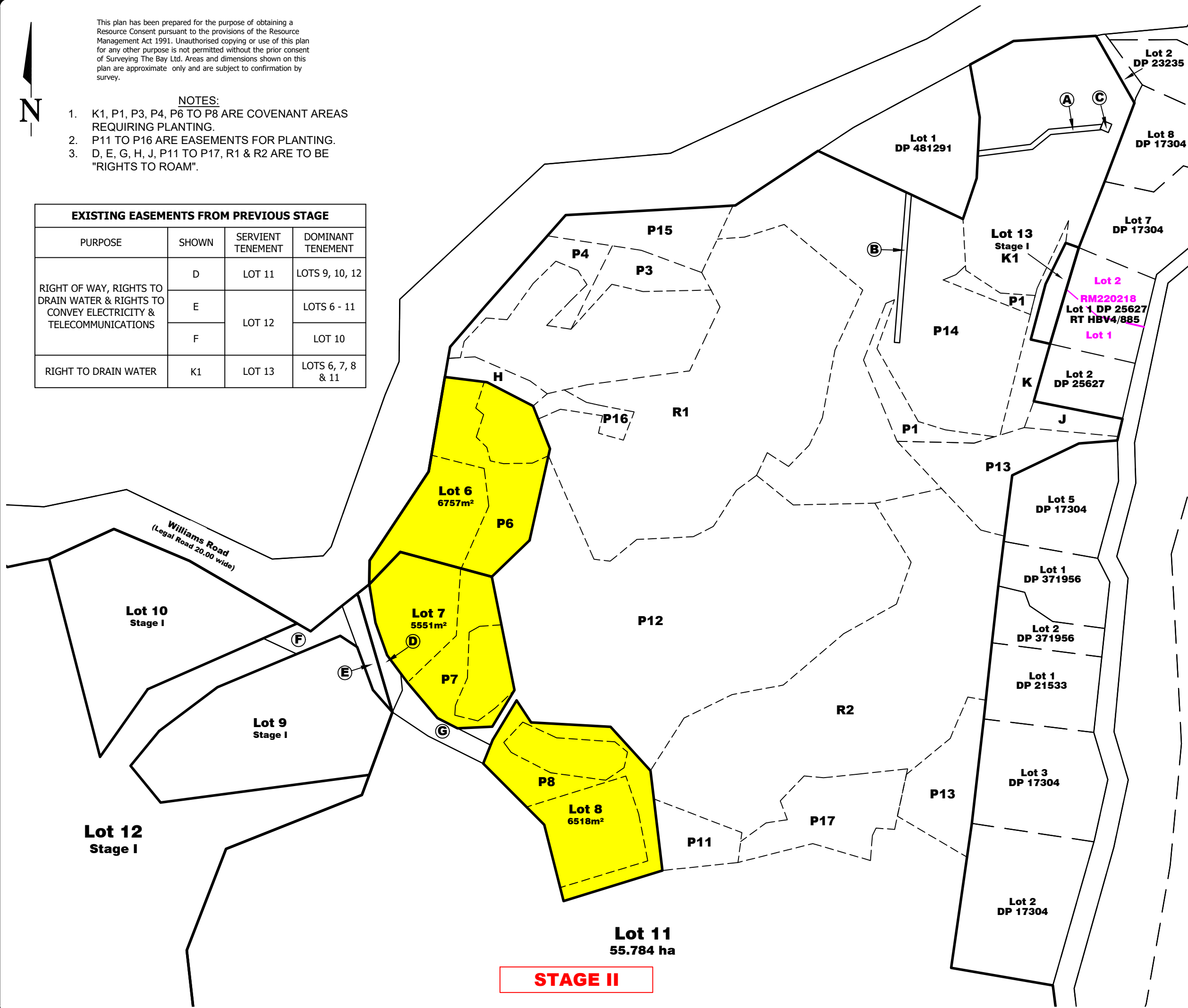

LOCAL AUTHORITY	: CENTRAL HAWKES BAY DISTRICT
ZONING	: RURAL
TOTAL AREA	: 111.9000 ha
COMPRISED IN	: RT 674477
REGISTERED OWNERS	: SR & BJ WILLIAMS CHARITABLE TRUST BOARD

PROPOSED EASEMENTS

PURPOSE	SHOWN	SERVIENT TENEMENT	DOMINANT TENEMENT
RIGHT OF WAY, RIGHTS TO DRAIN WATER & RIGHTS TO CONVEY ELECTRICITY & TELECOMMUNICATIONS	D	LOT 11	LOTS 7 & 8
	G		LOT 8

SCHEDULE OF EXISTING EASEMENTS

PURPOSE	SHOWN	SERVIENT TENEMENT	DOC.
RIGHT TO CONVEY ELECTRICITY	A	LOT 11	9894516.5
RIGHT TO CONVEY TELECOMMUNICATIONS AND COMPUTER MEDIA	B	LOT 11	

SCHEDULE OF EXISTING EASEMENT IN GROSS IN FAVOUR OF CENTRALINES LTD

PURPOSE	SHOWN	SERVIENT TENEMENT	DOC.
RIGHT TO CONVEY ELECTRICITY, TELECOMMUNICATIONS AND COMPUTER MEDIA	C	LOT 11	10063186.1

SR & BJ WILLIAMS CHARITABLE TRUST BOARD

PROPOSED SUBDIVISION OF
LOT 2 DP 481291
402 MANGAKURI ROAD,
MANGAKURI

SURVEYING THE BAY
HAWKES BAY | NEW ZEALAND

PO Box 611, Hastings, NZ
Phone: +64 6 870 4048 or 0800 787 842
Fax: +64 6 870 4042
info@surveyingthebay.co.nz
www.surveyingthebay.co.nz

STAGING PLAN

1: 2,000 @ A3	PT
AUGUST 2023	
4698-31	4/6

This plan has been prepared for the purpose of obtaining a Resource Consent pursuant to the provisions of the Resource Management Act 1991. Unauthorised copying or use of this plan for any other purpose is not permitted without the prior consent of Surveying The Bay Ltd. Areas and dimensions shown on this plan are approximate only and are subject to confirmation by survey.



NOTES:

1. K1, P1, P3, P4 ARE COVENANT AREAS REQUIRING PLANTING.
2. P11 TO P17 ARE EASEMENTS FOR PLANTING.
3. D, E, G, H, J, P11 TO P17, R1 & R2 ARE TO BE "RIGHTS TO ROAM".

EXISTING EASEMENTS FROM PREVIOUS STAGE

PURPOSE	SHOWN	SERVIENT TENEMENT	DOMINANT TENEMENT
RIGHT OF WAY, RIGHTS TO DRAIN WATER & RIGHTS TO CONVEY ELECTRICITY & TELECOMMUNICATIONS	D	LOT 11	LOTS 7 - 10, 12
	E	LOT 12	LOTS 6 - 11
	F	LOT 12	LOT 10
	G	LOT 11	LOT 8
RIGHT TO DRAIN WATER	K1	LOT 13	LOTS 3, 4, 6, 7, 8, 11

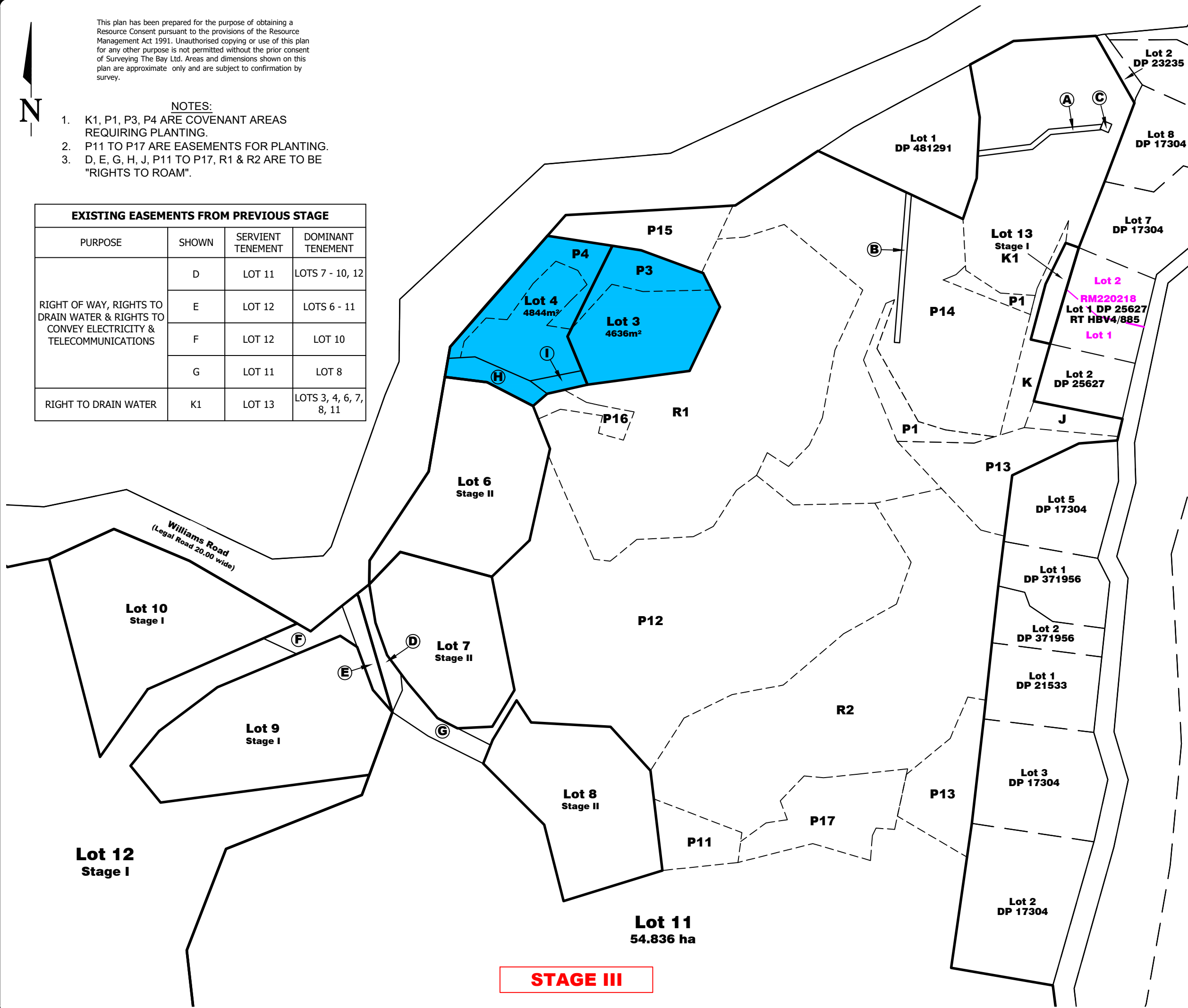

LOCAL AUTHORITY : CENTRAL HAWKES BAY DISTRICT
 ZONING : RURAL
 TOTAL AREA : 111.9000 ha
 COMPRISED IN : RT 674477
 REGISTERED OWNERS : SR & BJ WILLIAMS CHARITABLE TRUST BOARD

PROPOSED EASEMENTS

PURPOSE	SHOWN	SERVIENT TENEMENT	DOMINANT TENEMENT
RIGHT OF WAY, RIGHTS TO DRAIN WATER & RIGHTS TO CONVEY ELECTRICITY & TELECOMMUNICATIONS	H	LOT 4	LOTS 3 & 11
	I	LOT 4	LOT 3

SCHEDULE OF EXISTING EASEMENTS

PURPOSE	SHOWN	SERVIENT TENEMENT	DOC.
RIGHT TO CONVEY ELECTRICITY	A	LOT 11	9894516.5
RIGHT TO CONVEY TELECOMMUNICATIONS AND COMPUTER MEDIA	B	LOT 11	

SCHEDULE OF EXISTING EASEMENT IN GROSS IN FAVOUR OF CENTRALINES LTD

PURPOSE	SHOWN	SERVIENT TENEMENT	DOC.
RIGHT TO CONVEY ELECTRICITY, TELECOMMUNICATIONS AND COMPUTER MEDIA	C	LOT 11	10063186.1

SR & BJ WILLIAMS CHARITABLE TRUST BOARD

PROPOSED SUBDIVISION OF LOT 2 DP 481291
 402 MANGAKURI ROAD,
 MANGAKURI

SURVEYING THE BAY
 HAWKES BAY | NEW ZEALAND

PO Box 611, Hastings, NZ
 Phone: +64 6 870 4048 or 0800 787 842
 Fax: +64 6 870 4042
 info@surveyingthebay.co.nz
 www.surveyingthebay.co.nz

STAGING PLAN

1: 2,000 @ A3
 AUGUST 2023
 4698-31 | 5/6

This plan has been prepared for the purpose of obtaining a Resource Consent pursuant to the provisions of the Resource Management Act 1991. Unauthorised copying or use of this plan for any other purpose is not permitted without the prior consent of Surveying The Bay Ltd. Areas and dimensions shown on this plan are approximate only and are subject to confirmation by survey.



NOTES:

1. K1, P1, P3, P4 ARE COVENANT AREAS REQUIRING PLANTING.
2. P11 TO P17 ARE EASEMENTS FOR PLANTING.
3. D, E, G, H, J, P11 TO P17, R1 & R2 ARE TO BE "RIGHTS TO ROAM".

EXISTING EASEMENTS FROM PREVIOUS STAGE

PURPOSE	SHOWN	SERVIENT TENEMENT	DOMINANT TENEMENT
RIGHT OF WAY, RIGHTS TO DRAIN WATER & RIGHTS TO CONVEY ELECTRICITY & TELECOMMUNICATIONS	D	LOT 11	LOTS 7 - 10, 12
	E	LOT 12	LOTS 6 - 11
	F	LOT 12	LOT 10
	G	LOT 11	LOT 8
	H	LOT 4	LOTS 3 & 11
I	LOT 3		
RIGHT TO DRAIN WATER	K1	LOT 13	LOTS 1, 3, 4, 6 - 8 & 11

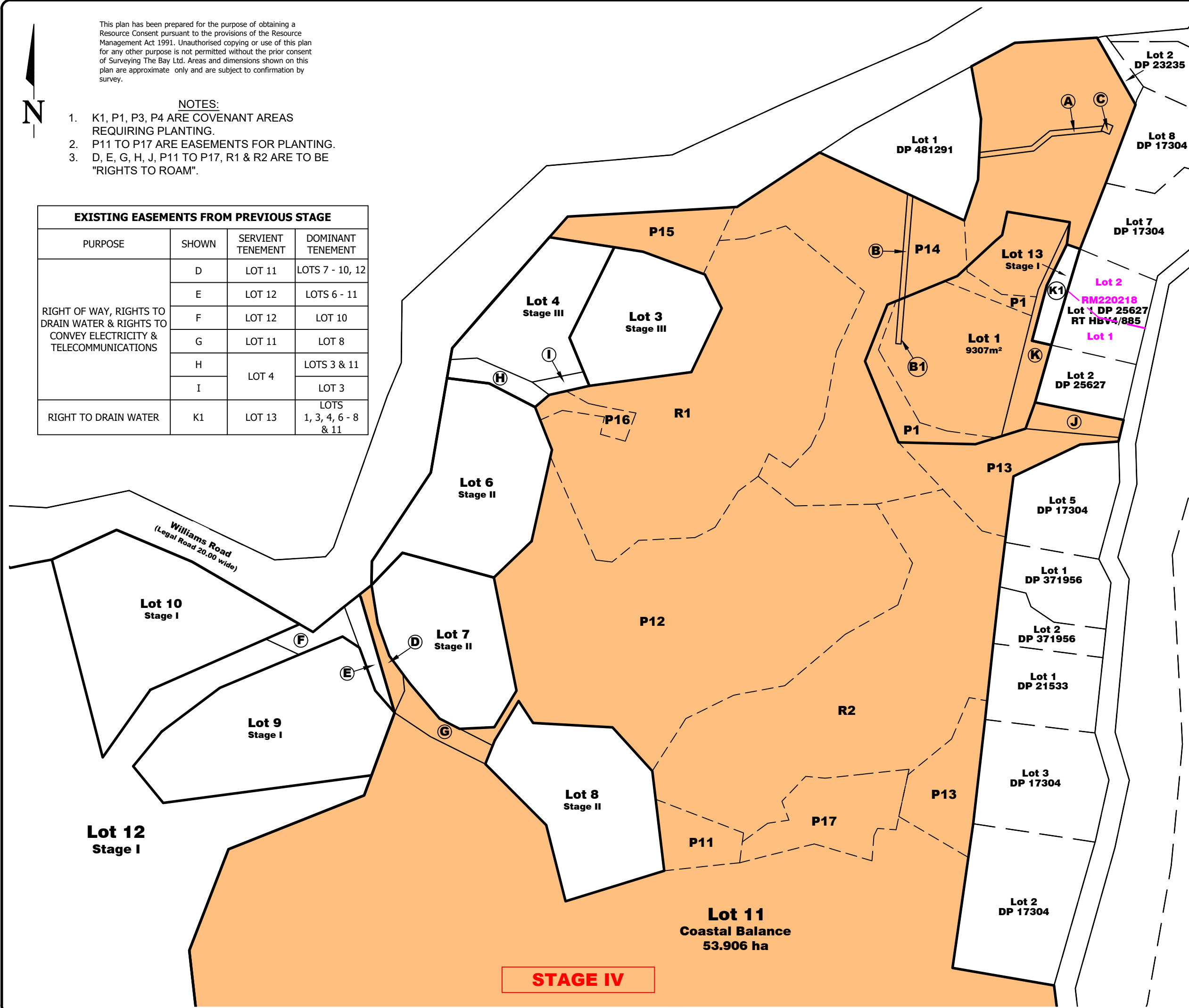

LOCAL AUTHORITY	: CENTRAL HAWKES BAY DISTRICT
ZONING	: RURAL
TOTAL AREA	: 111.9000 ha
COMPRISED IN	: RT 674477
REGISTERED OWNERS	: SR & BJ WILLIAMS CHARITABLE TRUST BOARD

PROPOSED EASEMENTS

PURPOSE	SHOWN	SERVIENT TENEMENT	DOMINANT TENEMENT
RIGHT OF WAY, RIGHTS TO DRAIN WATER & RIGHTS TO CONVEY ELECTRICITY & TELECOMMUNICATIONS	J	LOT 11	LOT 1
RIGHT TO DRAIN WATER	K	LOT 1	LOT 11

SCHEDULE OF EXISTING EASEMENTS

PURPOSE	SHOWN	SERVIENT TENEMENT	DOC.
RIGHT TO CONVEY ELECTRICITY	A	LOT 11	9894516.5
RIGHT TO CONVEY TELECOMMUNICATIONS AND COMPUTER MEDIA	B	LOT 11	
	B1	LOT 1	

SCHEDULE OF EXISTING EASEMENT IN GROSS IN FAVOUR OF CENTRALINES LTD

PURPOSE	SHOWN	SERVIENT TENEMENT	DOC.
RIGHT TO CONVEY ELECTRICITY, TELECOMMUNICATIONS AND COMPUTER MEDIA	C	LOT 11	10063186.1

SR & BJ WILLIAMS CHARITABLE TRUST BOARD

PROPOSED SUBDIVISION OF
LOT 2 DP 481291
402 MANGAKURI ROAD,
MANGAKURI

SURVEYING THE BAY
HAWKES BAY | NEW ZEALAND

PO Box 611, Hastings, NZ
Phone: +64 6 870 4048 or 0800 787 842
Fax: +64 6 870 4042
info@surveyingthebay.co.nz
www.surveyingthebay.co.nz

STAGING PLAN

Scale	: 1: 2,000 @ A3
Date	: AUGUST 2023
Project No.	: 4698-31
Page No.	: 6/6