

**CENTRAL HAWKE'S BAY DISTRICT  
COUNCIL  
BYLAWS**



**Part 26 – Speed Limits**

Superseding CHBDC:Part 26:2007

This bylaw needs to be reviewed once the full impacts of the new Setting of Speed Limits Rule comes into force and more is understood about the application of the speed management guidelines

## SCHEDULE OF AMENDMENTS

[illegible]

## **Bylaw for Speed Limits**

---

### **The Central Hawke's Bay District Council Speed Limits Bylaw 2018**

#### 1. Introduction

Pursuant to Section 684(1)(13) of the Local Government Act 1974, the Local Government Act 2002 and Land Transport Rule: Setting of Speed Limits 2003 the Central Hawkes Bay District Council makes this bylaw to set speed limits as specified in the schedules.

#### 2. Title

The title of this bylaw is the Central Hawkes Bay District Council Speed Limits Bylaw 2018.

#### 3. Date the speed limits come into force

The speed limits described in the schedules come into force on the date specified in the schedules.

#### 4. Interpretation:

**Reference should be made to Part 1 *Introductory Bylaw* and to the legislation referred to under Referenced Documents, for any other definitions not included in this Part.**

Road means the same as in Land Transport Rule: Setting of Speed Limits 2003

Speed limit means the same as in Land Transport Rule: Setting of Speed Limits 2003

Urban traffic area means the same as in Land Transport Rule: Setting of Speed Limits 2003

#### 5. Speed limits

The roads or areas described in the schedules specified in Section 6 or as shown on a map referenced in the schedules are declared to have the speed limits specified in the schedules and maps, which are part of this bylaw.

#### 6. Schedules

Schedule 1: Roads that have a speed limit of 20 km/h

Schedule 2: Roads that have a speed limit of 30 km/h.

Schedule 3: Roads that have a speed limit of 40 km/h (*Schedule 3 is not used in this bylaw*).

Schedule 4: Urban traffic areas - roads that have a speed limit of 50 km/h.

Schedule 5: Roads that have a speed limit of 60 km/h. (*Schedule 5 is not used in this bylaw*).

**Schedule 6: Roads that have a speed limit of 70 km/h.**

Schedule 7: Roads that have a speed limit of 80 km/h.

Schedule 8: Rural areas - roads that have a speed limit of 100 km/h.

Schedule 9: Roads that have a holiday speed limit.

Schedule 10: Roads that have a variable speed limit (*Schedule 10 is not used in this bylaw*).

Schedule 11: Roads that have a minimum speed limit (*Schedule 11 is not used in this bylaw*).

### **7 BYLAW APPROVAL DATE**

The Common Seal of the Central Hawke's Bay District Council was attached, under Resolution (*Reference – Part 26:Speed Limits Bylaw 2018*) passed at a

meeting of the Central Hawke's Bay District Council held on .....  
(Day) ..... (Month) ..... (Year).

*DATE CONFIRMED :* \_\_\_\_/\_\_\_\_/\_\_\_\_

Schedule 1      20 km/h

The roads or areas described in this schedule or as shown on a map referenced in this schedule are declared to have a speed limit of 20 km/h.

Reference Number	Speed Limit	Description	Date Speed Limit Comes into Force	Legal Instrument	Previous Legal Instrument
01/01	20km/h	<p>At Pourerere Beach</p> <p>All the roads or areas marked on the map entitled "Central Hawke's Bay District Council Speed Limits at Pourerere Beach", number CHBDC01/01 and identified in the legend as having a speed limit of 20km/h.</p>	1 <sup>st</sup> July 2005	Central Hawkes Bay District Council Speed Limits Bylaw 2005.	None

Schedule 2      30 km/h

The roads or areas described in this schedule or as shown on a map referenced in this schedule are declared to have a speed limit of 30 km/h.

Reference Number	Speed Limit	Description	Date Speed Limit Comes into Force	Legal Instrument	Previous Legal Instrument
02/01	30km/h	At Mangakuri Beach:  All the roads or areas marked on the map entitled "Central Hawke's Bay District Council Speed Limits at Mangakuri Beach", number CHBDC02/01 and identified in the legend as having a speed limit of 30km/h.	01 July 2005	Central Hawkes Bay District Council Speed Limits Bylaw 2005.	None
02/02	30km/h	At Blackhead Beach:  All the roads or areas marked on the map entitled "Central Hawke's Bay District Council Speed Limits at Blackhead Beach", number CHBDC02/02 and identified in the legend as having a speed limit of 30km/h.	01 July 2005	Central Hawkes Bay District Council Speed Limits Bylaw 2005.	None
02/03	30km/h	At Kairakau:  All the roads or areas marked on the map entitled "Central Hawke's Bay District Council Speed Limits at Kairakau Beach", number CHBDC02/03 and identified in the legend as having a speed limit of 30km/h.	01 July 2005	Central Hawkes Bay District Council Speed Limits Bylaw 2005.	None

Schedule 4 Urban traffic areas – 50 km/h

The roads or areas described in this schedule or as shown on a map referenced in this schedule are declared to be urban traffic areas that have a speed limit of 50 km/h, except for those roads or areas that are:

(a) described as having a different speed limit in the appropriate schedule of this bylaw; or

(b) shown on a map as having a different speed limit, as referenced in the appropriate schedule of this bylaw.

Reference Number	Speed Limit	Description	Date Speed Limit Comes into Force	Legal Instrument	Previous Legal Instrument
04/01	50km/h	At Waipukurau:  All the roads or areas marked on the map entitled “Central Hawke’s Bay District Council Speed Limits at Waipukurau”, number CHBDC04/01 and identified in the legend as having a speed limit of 50km/h, except for those roads or areas that are marked on the said map and identified in the legend as having a different speed limit, as referenced in the appropriate schedule of this bylaw.	01 July 2005	Central Hawkes Bay District Council Speed Limits Bylaw 2005.	Section 52(1) of the Transport Act 1962 and Notice in the New Zealand Gazette, 19 September 1991, No.140, p.2992.
04/02	50km/h	At Waipawa:  All the roads or areas marked on the map entitled “Central Hawke’s Bay District Council Speed Limits at Waipawa”, number CHBDC04/02 and identified in the legend as having a speed limit of 50km/h, except for those roads or areas that are marked on the said map and identified in the legend as having a different speed limit, as referenced in the appropriate schedule of this bylaw.	01 July 2005  Revised on 29 March 2007	Central Hawkes Bay District Council Speed Limits Bylaw 2005.	Section 52(1) of the Transport Act 1962 and Notice in the New Zealand Gazette, 19 September 1991, No.140, p.2992.

Reference Number	Speed Limit	Description	Date Speed Limit Comes into Force	Legal Instrument	Previous Legal Instrument
04/03	50km/h	At Kairakau Beach:  All the roads or areas marked on the map entitled “Central Hawke’s Bay District Council Speed Limits at Kairakau Beach”, number CHBDC02/03 and identified in the legend as having a speed limit of 50km/h, except for those roads or areas that are marked on the said map and identified in the legend as having a different speed limit, as referenced in the appropriate schedule of this bylaw.	01 July 2005	Central Hawkes Bay District Council Speed Limits Bylaw 2005.	Section 52(1) of the Transport Act 1962 and Notice in the New Zealand Gazette, 19 September 1991, No.140, p.2992.
04/04	50km/h	At Otane:  All the roads or areas marked on the map entitled “Central Hawke’s Bay District Council Speed Limits at Otane”, number CHBDC04/04 and identified in the legend as having a speed limit of 50km/h, except for those roads or areas that are marked on the said map and identified in the legend as having a different speed limit, as referenced in the appropriate schedule of this bylaw.	01 July 2005	Central Hawkes Bay District Council Speed Limits Bylaw 2005.	Section 52(1) of the Transport Act 1962 and Notice in the New Zealand Gazette, 19 September 1991, No.140, p.2992.
04/05	50km/h	At Porangahau:  All the roads or areas marked on the map entitled “Central Hawke’s Bay District Council Speed Limits at Porangahau”, number CHBDC04/05 and identified in the legend as having a speed limit of 50km/h, except for those roads or areas that are marked on the said map and identified in the legend as having a different speed limit, as referenced in the appropriate schedule of this bylaw.	01 July 2005	Central Hawkes Bay District Council Speed Limits Bylaw 2005.	Section 52(1) of the Transport Act 1962 and Notice in the New Zealand Gazette, 19 September 1991, No.140, p.2992.



Reference Number	Speed Limit	Description	Date Speed Limit Comes into Force	Legal Instrument	Previous Legal Instrument
04/06	50km/h	<p>At Te Paerahi Beach (Porangahau Beach):</p> <p>All the roads or areas marked on the map entitled “Central Hawke’s Bay District Council Speed Limits at Porangahau Beach”, number CHBDC04/06 and identified in the legend as having a speed limit of 50km/h, except for those roads or areas that are marked on the said map and identified in the legend as having a different speed limit, as referenced in the appropriate schedule of this bylaw.</p>	01 July 2005	Central Hawkes Bay District Council Speed Limits Bylaw 2005.	Section 52(1) of the Transport Act 1962 and Notice in the New Zealand Gazette, 19 September 1991, No.140, p.2992.
04/07	50km/h	<p>At Onga Onga:</p> <p>All the roads or areas marked on the map entitled “Central Hawke’s Bay District Council Speed Limits at Onga Onga”, number CHBDC04/07 and identified in the legend as having a speed limit of 50km/h, except for those roads or areas that are marked on the said map and identified in the legend as having a different speed limit, as referenced in the appropriate schedule of this bylaw.</p>	01 July 2005	Central Hawkes Bay District Council Speed Limits Bylaw 2005.	Section 52(1) of the Transport Act 1962 and Notice in the New Zealand Gazette, 19 September 1991, No.140, p.2992.

Schedule 4 (continued) Urban traffic areas – 50 km/h

Reference Number	Speed Limit	Description	Date Speed Limit Comes into Force	Legal Instrument	Previous Legal Instrument
04/08	50km/h	<p>At Takapau:</p> <p>All the roads or areas marked on the map entitled “Central Hawke’s Bay District Council Speed Limits at Takapau”, number CHBDC04/08 and identified in the legend as having a speed limit of 50km/h, except for those roads or areas that are marked on the said map and identified in the legend as having a different speed limit, as referenced in the appropriate schedule of this bylaw.</p>	01 July 2005	Central Hawkes Bay District Council Speed Limits Bylaw 2005.	Section 52(1) of the Transport Act 1962 and Notice in the New Zealand Gazette, 19 September 1991, No.140, p.2992.
04/09	50km/h	<p>At Tikokino:</p> <p>All the roads or areas marked on the map entitled “Central Hawke’s Bay District Council Speed Limits at Tikokino”, number CHBDC04/09 and identified in the legend as having a speed limit of 50km/h, except for those roads or areas that are marked on the said map and identified in the legend as having a different speed limit, as referenced in the appropriate schedule of this bylaw.</p>	01 July 2005	Central Hawkes Bay District Council Speed Limits Bylaw 2005.	Section 52(1) of the Transport Act 1962 and Notice in the New Zealand Gazette, 19 September 1991, No.140, p.2992.

Schedule 4 (continued) Urban traffic areas – 50 km/h

Reference Number	Speed Limit	Description	Date Speed Limit Comes into Force	Legal Instrument	Previous Legal Instrument
04/10	50km/h	At Aramoana:  All the roads or areas marked on the map entitled “Central Hawke’s Bay District Council Speed Limits at Aramoana”, number CHBDC04/10 and identified in the legend as having a speed limit of 50km/h, except for those roads or areas that are marked on the said map and identified in the legend as having a different speed limit, as referenced in the appropriate schedule of this bylaw.	01 July 2005	Central Hawkes Bay District Council Speed Limits Bylaw 2005.	None
04/11	50km/h	At Whangaehu:  All the roads or areas marked on the map entitled “Central Hawke’s Bay District Council Speed Limits at Whangaehu”, number CHBDC04/11 and identified in the legend as having a speed limit of 50km/h, except for those roads or areas that are marked on the said map and identified in the legend as having a different speed limit, as referenced in the appropriate schedule of this bylaw.	01 July 2005	Central Hawkes Bay District Council Speed Limits Bylaw 2005.	None
04/12	50km/h	At Pourerere:  All the roads or areas marked on the map entitled “Central Hawke’s Bay District Council Speed Limits at Pourerere”, number CHBDC01/01 and identified in the legend as having a speed limit of 50km/h, except for those roads or areas that are marked on the said map and identified in the legend as having a different speed limit, as referenced in the appropriate schedule of this bylaw.	01 July 2005	Central Hawkes Bay District Council Speed Limits Bylaw 2005.	None

Schedule 6 70 km/h need to update maps

The roads or areas described in this schedule or as shown on a map referenced in this schedule are declared to have a speed limit of 70 km/h.

Reference Number	Speed Limit	Description	Date Speed Limit Comes into Force	Legal Instrument	Previous Legal Instrument
06/01	70km/h	At Waipukurau:  All the roads or areas marked on the map entitled "Central Hawke's Bay District Council Speed Limits at Waipukurau", number CHBDC04/01 and identified in the legend as having a speed limit of 70km/h.	01 July 2005	Central Hawkes Bay District Council Speed Limits Bylaw 2005.	Regulation 21 (2) of the Traffic Regulations 1976. Notice in the New Zealand Gazette, 19 September 1991, No.140, p.2992.
06/02	70km/h	At Waipawa:  All the roads or areas marked on the map entitled "Central Hawke's Bay District Council Speed Limits at Waipawa", number CHBDC04/02 and identified in the legend as having a speed limit of 70km/h.	01 July 2005	Central Hawkes Bay District Council Speed Limits Bylaw 2005.	Regulation 21 (2) of the Traffic Regulations 1976. Notice in the New Zealand Gazette, 19 September 1991, No.140, p.2992.

## Schedule 6 (continued)

70 km/h

Reference Number	Speed Limit	Description	Date Speed Limit Comes into Force	Legal Instrument	Previous Legal Instrument
06/03	70km/h	At Takapau:  All the roads or areas marked on the map entitled "Central Hawke's Bay District Council Speed Limits at Takapau", number CHBDC04/08 and identified in the legend as having a speed limit of 70km/h.	01 July 2005	Central Hawkes Bay District Council Speed Limits Bylaw 2005.	None
06/04	70km/h	At Te Paerahi (Porangahau Beach):  All the roads or areas marked on the map entitled "Central Hawke's Bay District Council Speed Limits at Te Paerahi (Porangahau Beach)", number CHBDC04/06 and identified in the legend as having a speed limit of 70km/h.	01 July 2005	Central Hawkes Bay District Council Speed Limits Bylaw 2005.	None
06/05	70km/h	At Otane:  All the roads or areas marked on the map entitled "Central Hawke's Bay District Council Speed Limits at Otane", number CHBDC04/04 and identified in the legend as having a speed limit of 70km/h.	01 July 2005	Central Hawkes Bay District Council Speed Limits Bylaw 2005.	None

Schedule 7      80 km/h need to update maps

The roads or areas described in this schedule or as shown on a map referenced in this schedule are declared to have a speed limit of 80 km/h.

Reference Number	Speed Limit	Description	Date Speed Limit Comes into Force	Legal Instrument	Previous Legal Instrument
07/01	80km/h	At Waipukurau:  All the roads or areas marked on the map entitled "Central Hawke's Bay District Council Speed Limits at Waipukurau", number CHBDC04/01 and identified in the legend as having a speed limit of 80km/h.	01 July 2005	Central Hawkes Bay District Council Speed Limits Bylaw 2005	Regulation 21 (2) of the Traffic Regulations 1976. Notice in the New Zealand Gazette, 19 September 1991, No.140, p.2992.

Schedule 8 Rural areas – 100 km/h

The roads or areas described in this schedule or as shown on a map referenced in this schedule are declared to be rural areas that have a speed limit of 100 km/h.

Reference Number	Speed Limit	Description	Date Speed Limit Comes into Force	Legal Instrument	Previous Legal Instrument
S8/01	100 km/h	<p>All Central Hawke's Bay District Council roads outside an urban traffic area listed in Schedule 4 have a speed limit of 100 km/h, except for roads or areas that are:</p> <p>(a) described as having a different speed limit in the appropriate schedule of this bylaw; or</p> <p>(b) shown on a map as having a different speed limit, as referenced in the appropriate schedule of this bylaw.</p>	01 July 2005	Clause 2.3 Land Transport Rule: Setting of Speed Limits 2003.	Regulation 21(1) Traffic Regulation 1976.

Schedule 9      Holiday speed limits

The roads or areas described in this schedule or as shown on a map referenced in this schedule are declared to have a holiday speed limit as specified in this schedule.

Reference Number	Speed Limit	Description	Date Speed Limit Comes into Force	Legal Instrument	Previous Legal Instrument
06/06	30km/h holiday speed limit	<p>At Te Paerahi Beach (Porangahau Beach):</p> <p>The roads as marked on the map entitled "Central Hawke's Bay District Council Speed Limits at Te Paerahi Beach (Porangahau Beach)" number CHBDC04/06 and identified in the legend as having a Holiday speed limit of 30 km/h during the following periods:</p> <p>1.Beginning on 20 December each year and ending on 31 January the following year (both dates included); and</p> <p>2.Beginning on the Thursday before Easter and ending on the Tuesday after Easter each year (both days included).</p> <p>3.At all other times the roads described in this entry of this schedule have a speed limit of 50 km/h, as described in Schedule 4, reference number 04/06</p>	As specified in the description in this entry of this schedule.	Central Hawkes Bay District Council Speed Limits Bylaw 2005.	Regulation 21 (2) of the Traffic Regulations 1976. Notice in the New Zealand Gazette, 19 September 1991, No.140, p.2992.



## Schedule 9 (continued)

## Holiday speed limits

Reference Number	Speed Limit	Description	Date Speed Limit Comes into Force	Legal Instrument	Previous Legal Instrument
06/07	20km/h holiday speed limit	<p>At Pourerere Beach:</p> <p>The roads as marked on the map entitled "Central Hawke's Bay District Council Speed Limits at Pourerere Beach" number CHBDC01/01 and identified in the legend as having a Holiday speed limit of 20 km/h during the following periods:</p> <p>1.Beginning on 20 December each year and ending on 31 January the following year (both dates included); and</p> <p>2.Beginning on the Thursday before Easter and ending on the Tuesday after Easter each year (both days included).</p> <p>3.At all other times the roads described in this entry of this schedule have a speed limit of 50 km/h, as described in Schedule 4, reference number 04/12.</p>	As specified in the description in this entry of this schedule.	Central Hawkes Bay District Council Speed Limits Bylaw 2005	Regulation 21 (2) of the Traffic Regulations 1976. Notice in the New Zealand Gazette, 19 September 1991, No.140, p.2992.

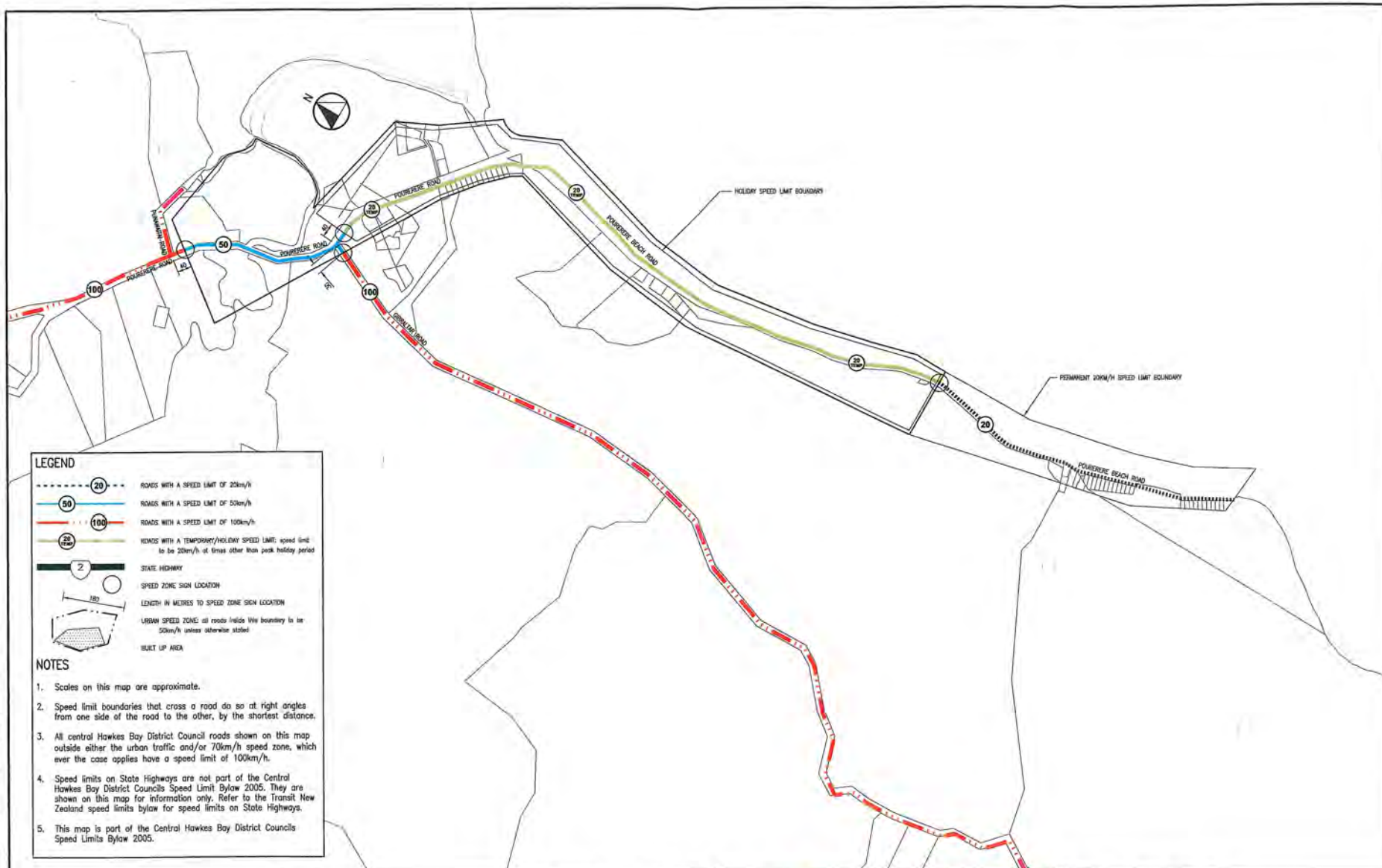

BY	CHECKED	DATE
DESIGN		
DRAWN	J. Phillips	06/05
RECORDS		
APPROVED		
This drawing and its contents are the property of Opus International Consultants Limited. Any unauthorized employment or reproduction, in full or in part, is prohibited.		
AMENDMENT	APP'D	DATE



FILE: CENTRAL HAWKES BAY DISTRICT COUNCIL SPEED LIMITS AT POURERERE BEACH CHBDC 01/01	
POURERERE BEACH SPEED ZONES	
STATUS	FILE: 2-W2007.10.002NW
SCALE: 1:10,000 [A3]	PLOT DATE: 27/06/05 @ 11:47 FEATURE IDENTIFIER: 3/1066/188 CODE: 9304 SHEET: 9 REVISION:

